

## Magnetostrictive Position Sensor

- Measuring range 100 - 900 mm
- 16 bit resolution
- Output 0-10V
- 24 VDC power supply



### Technical specifications

Measurement stroke	100 to 900 mm
Resolution	16 bit ( 200µm )
Repeatability	< 0.05 mm
Output	0...10V
Power supply	24 VDC ±10%
Displacement speed	< 10 m/s
Sampling rate	1 Khz
Max. consumption	50mA
Max. output noise	< 5mVpp
Max. output value	10.5 Volt
Reverse polarity protection	Yes

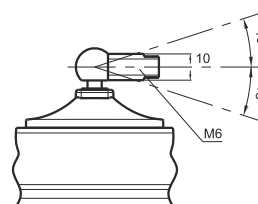
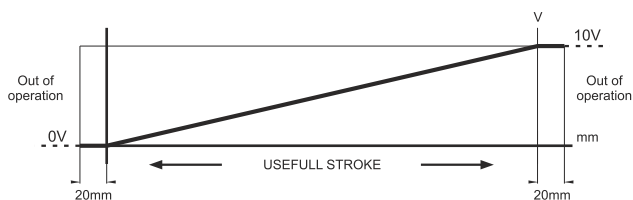
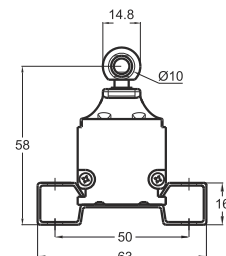
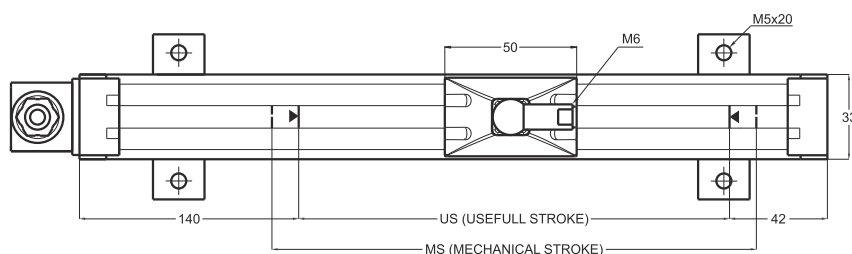
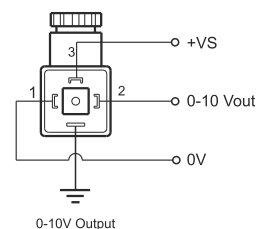
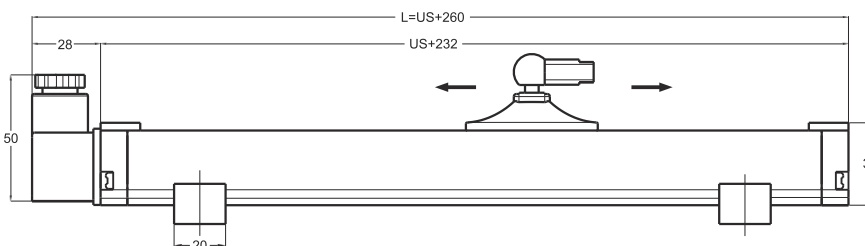

MSH (mm)	100	150	200	250	300	350	400	450	500	550	600	650	700	750	800	850	900
US (Usefull Stroke)	150	200	250	300	350	400	450	500	550	600	650	700	750	800	850	900	950
MS (Mechanical Stroke)	190	240	290	340	390	440	490	540	590	640	690	740	790	840	890	940	990
L (Total Length)	360	410	460	510	560	610	660	710	760	810	860	910	960	1010	1060	1110	1160

Model	Measurment stroke	Resolution	Output	Connector / Cable
(example) MSH	300	A	V10	C1
MSH	100 ... 900mm	A : 16 bit	V10 : 0-10V I 04 : 4-20mA I 20 : 0-20mA	C1 : 4 pin connector